



MAXIMACE
easier > faster > stronger >

Industrial Shock Absorbers for the PET Industry

**Ideal for Stretch Rod and Mold Applications on Sidel and
Krones PET machines**

PET-27MX-880

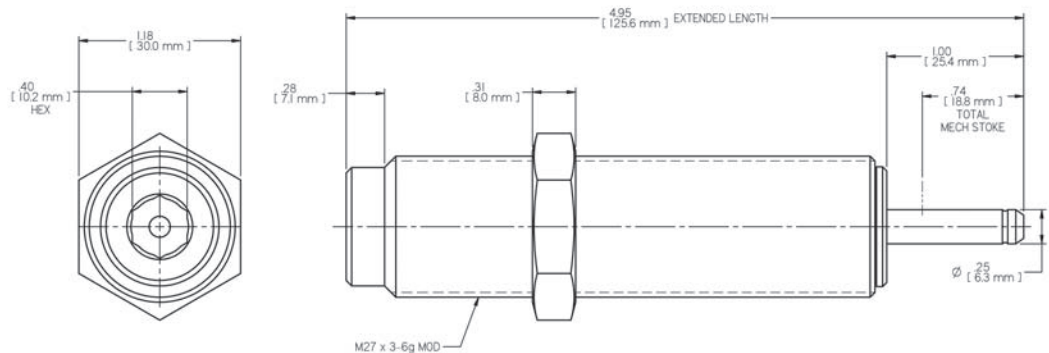

PET-27MX-NB

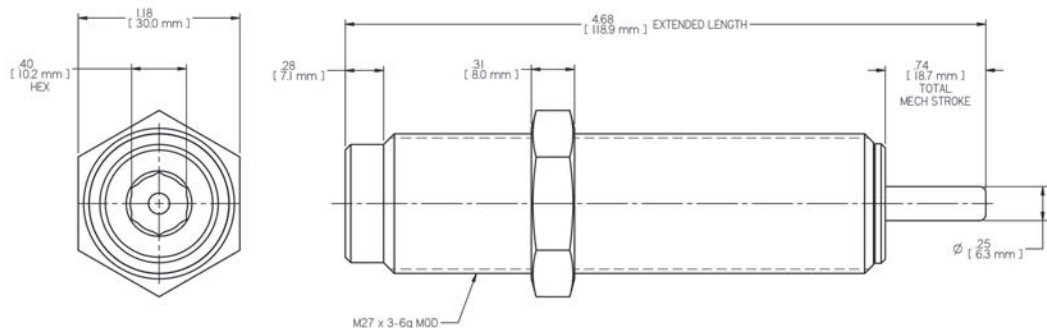

PET-27MX-QCM-880

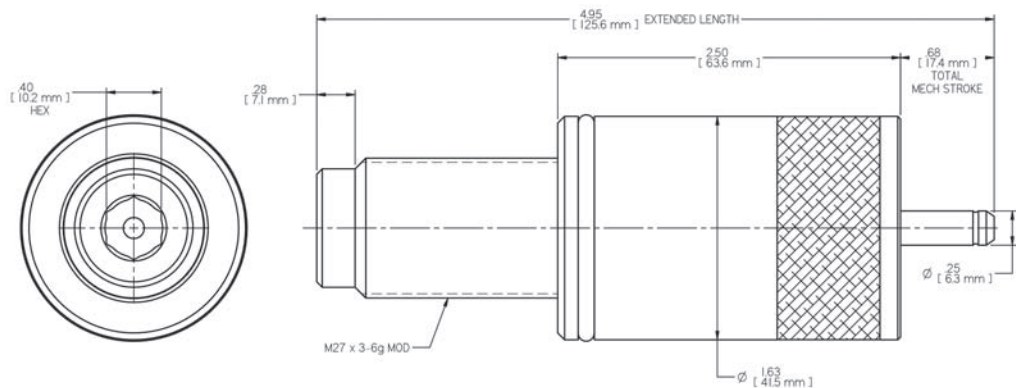

PET-27MX-SBUC

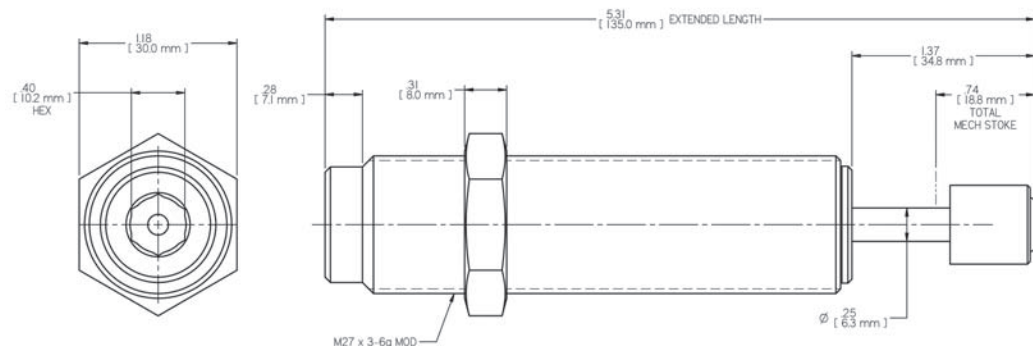

TECHNICAL DATA

E4 Energy per hour: 1.8M in-lbs (203,373 Nm)

Rod return time: 0.10 second

Return force: Initial: 3.8 lbs (1.72 kg)

Compressed: 7.1 lbs (3.22 kg)

Shipping weight: 0.44 lb (.20 kg)

Materials: Aluminum outer tube, chrome plated piston rod

PET Series & Model Number: PET 27M

Effective Weight*: -1 Ultralight -3 Medium

NOMENCLATURE

PET27M 1 - QCM

SERIES MODEL NUMBER	EFFECTIVE WEIGHT	MOUNT, BUTTON OPTIONS
PET 27M	-1 Ultra Light -3 Medium	<ul style="list-style-type: none">• QCM Quick Change Mount• SBUC Small Button, Urethane Cap• 880 No Button, Standard Rod• NB No Button, Short Rod• When using ACE Shock Stop Holders, you only need to inventory one shock model• Krones Shock Stop Holder used with –SBUC <p>* Additional models available for custom applications.</p>