

DIMENSIONI ATTUATORE TELESCOPICO "LATT"

TELESCOPIC ACTUATOR "LATT" DIMENSIONS

(*)CORSE STANDARD DISPONIBILI

50,100,150,200,250,300 mm

Corse diverse su richiesta

(*)AVAILABLE STANDARD STROKES

50,100,150,200,250,300 mm

Different strokes on request

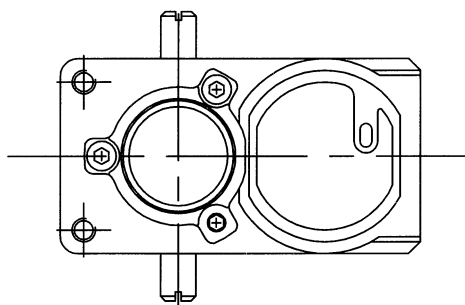
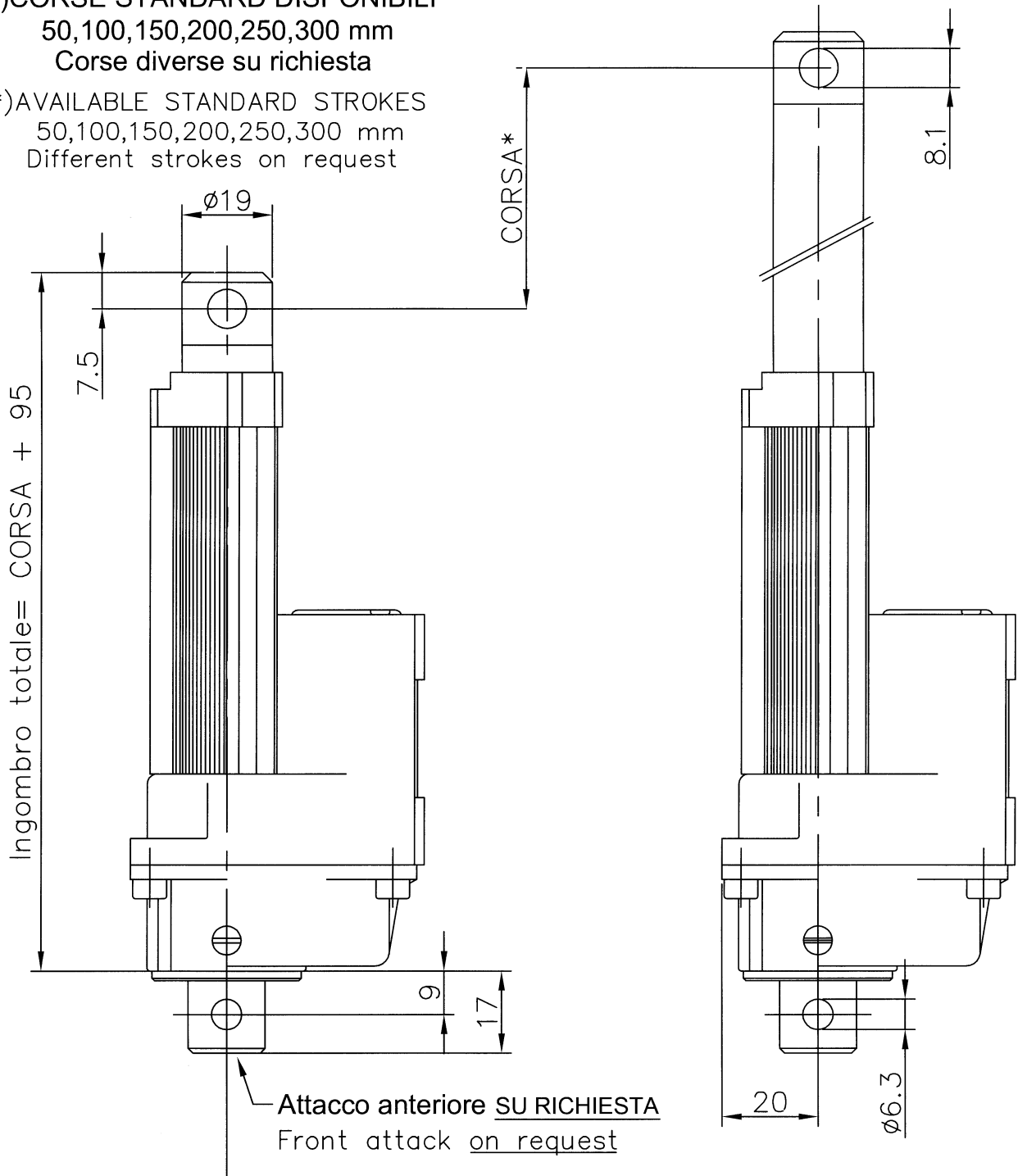

PER QUOTE NON INDICATE VEDI SCHEDA
"Dimensioni attuatore lineare LAT"

FOR NOT INDICATED DIMENSIONS SEE
"Linear actuator LAT dimensions"

PER CARATTERISTICHE ELETTROMECCANICHE VEDI SCHEDA
"Caratteristiche attuatori LAT"

FOR ELECTROMECHANICAL CHARACTERISTICS SEE
"Actuators characteristics LAT"



Caratteristiche ATTUATORI

ACTUATORS Characteristics

TENSIONE 12/24Vcc
VOLTAGE 12/24Vdc

	MOTORE 4A MOTOR 4A	MOTORE 2A MOTOR 2A	MOTORE 1A MOTOR 1A	MOTORE 0.5A MOTOR 0.5A
RAPPORTO 1/12 RATIO 1/12	<p>LAT 4A* 1/12</p>	<p>LAT 2A 1/12</p>	<p>LAT 1A 1/12</p>	<p>LAT 0.5A 1/12</p>
RAPPORTO 1/27 RATIO 1/27	<p>LAT 4A* 1/27</p>	<p>LAT 2A 1/27</p>	<p>LAT 1A 1/27</p>	<p>LAT 0.5A 1/27</p>
RAPPORTO 1/48 RATIO 1/48	<p>LAT 4A* 1/48</p>	<p>LAT 2A 1/48</p>	<p>LAT 1A 1/48</p>	<p>LAT 0.5A 1/48</p>
RAPPORTO 1/108 RATIO 1/108	<p>LAT 4A* 1/108</p>	<p>LAT 2A 1/108</p>	<p>LAT 1A 1/108</p>	<p>LAT 0.5A 1/108</p>
CICLI FUNZIONALI DUTY CYCLES	<p><u>4A Ciclo funzionale:</u> (*) solo 12 V</p> <p><u>4A Duty cycle:</u> (*) only 12 V</p> <p>20% On 80% Off</p>	<p><u>2A Ciclo funzionale (12V):</u> <u>2A Duty cycle (12V):</u></p> <p>50% On 50% Off</p> <p><u>2A Ciclo funzionale (24V):</u> <u>2A Duty cycle (24V):</u></p> <p>20% On 80% Off</p>	<p><u>1A Ciclo funzionale (12V):</u> <u>1A Duty cycle (12V):</u></p> <p>80% On 20% Off</p> <p><u>1A Ciclo funzionale (24V):</u> <u>1A Duty cycle (24V):</u></p> <p>50% On 50% Off</p>	<p><u>0.5A Ciclo funzionale (12V):</u> <u>0.5A Duty cycle (12V):</u></p> <p>90% On 10% Off</p> <p><u>0.5A Ciclo funzionale (24V):</u> <u>0.5A Duty cycle (24V):</u></p> <p>80% On 20% Off</p>

NOTE GENERALI:
GENERAL NOTES:

- il motore da 4A viene fornito solo a 12 Vc.c.
-4A motor available only to 12 Vd.c
- potenza resa ottimale al 50% corrente max (zona grafico non tratteggiata)
-optimal power yield to 50% max.current (look grafic in zone without sketch)
- sovratemperatura max.70° C - A richiesta protettore termico incorporato
-max.overtemperature 70° C - on request termic protector inside